

FORM NO 1.

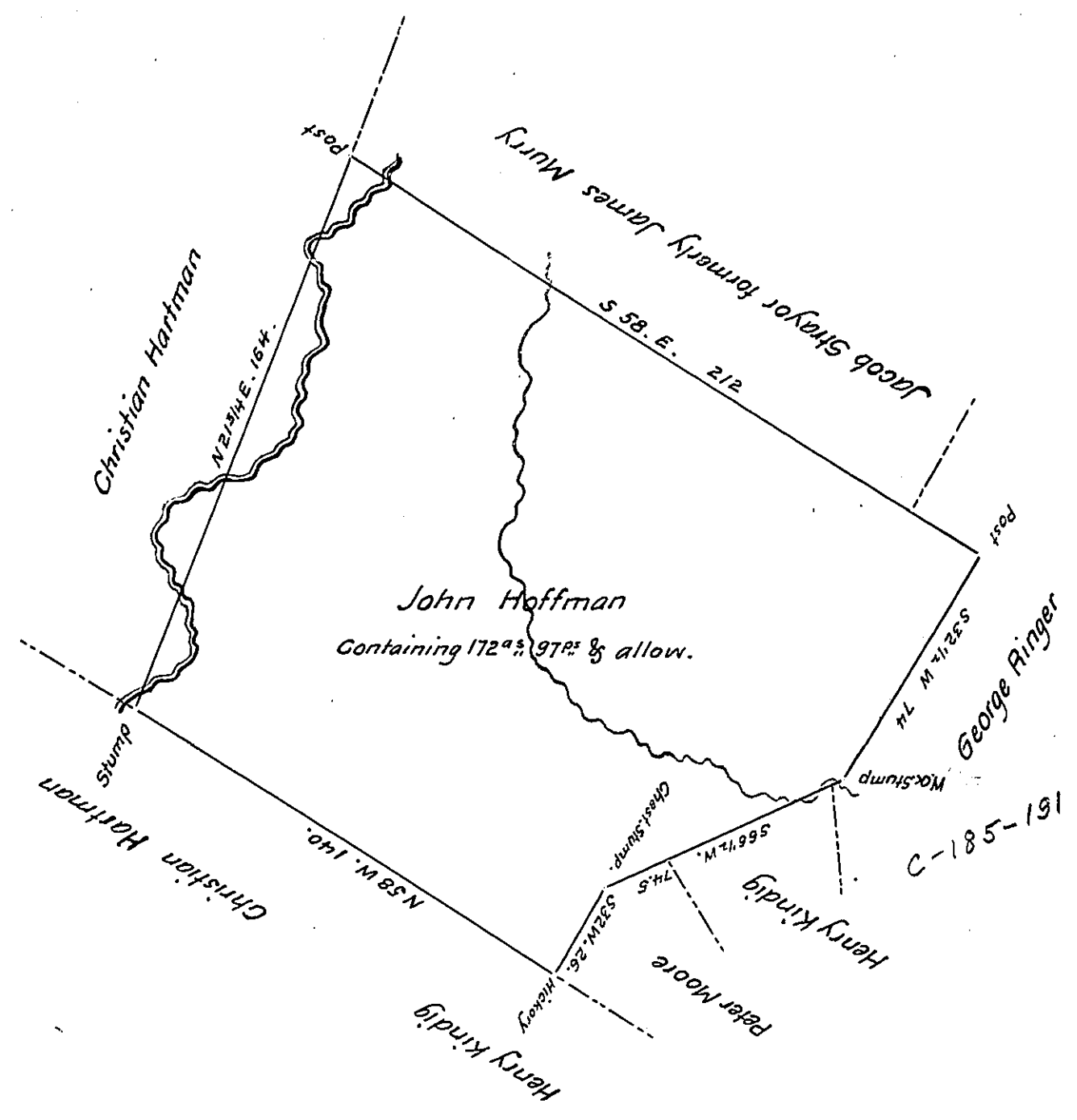

Situate in Manchester township in the County of York Containing as above set forth 172<sup>ac</sup> 97 perches and the usual allowance &c<sup>a</sup>. Originally Surveyed by Charles Lukens late D.S. in pursuance of a Warrant granted to John Hoffman for 100<sup>ac</sup> dated the 28<sup>th</sup> day of October 1746. Resurveyed by the old lines on the 23<sup>d</sup> day of December 1828. and Returned per Contract. Owned and occupied by Henry Kindig, Christian Hartman & George Ringer.

To Gabriel Hiester Esq<sup>r</sup>. }  
 Surveyor General. } Dan<sup>l</sup>. Small D.S.

IN TESTIMONY that the above is a copy of the original remaining on file in the Department of Internal Affairs of Pennsylvania, made conformably to an Act of Assembly approved the 16th day of February, 1833, I have hereunto set my Hand and caused the Seal of said Department to be affixed at Harrisburg, this nineteenth day of January 1909.

*Henry Howell*  
 Secretary of Internal Affairs.